

SHOWER WASTE BONDEVIEGA60/90

SUMMARY

1. Quality standard
2. Product overview
3. Assembly
4. Maintenance/Cleaning

1. Quality standard

All our products correspond to the active standards related to sanitary furniture, namely NF-22 for bathroom furniture and EN-251 for shower equipment.

2. Product overview

BONDEVIEGA60/90 drain: Ultra fast flow. Horizontal outlet. Collecting basket. Easy to clean. Access to pipes.

3. Assembly



- 1 - cover plate (Not Included)
- 2 - immersion pipe
- 3 - fixing flange with screws
- 4 - seal
- 5 - odour trap
- 6 - sealing ring
- 7 - sliding ring
- 8 - union nut
- 9 - drain elbow (Not Supplied)

Mounting conditions

The following requirements exist for the mounting of the drain:

- The shower tray is installed.
- The drainage line is installed all the way to the shower tray.
- The underside of the shower tray is accessible.

Dimensions :

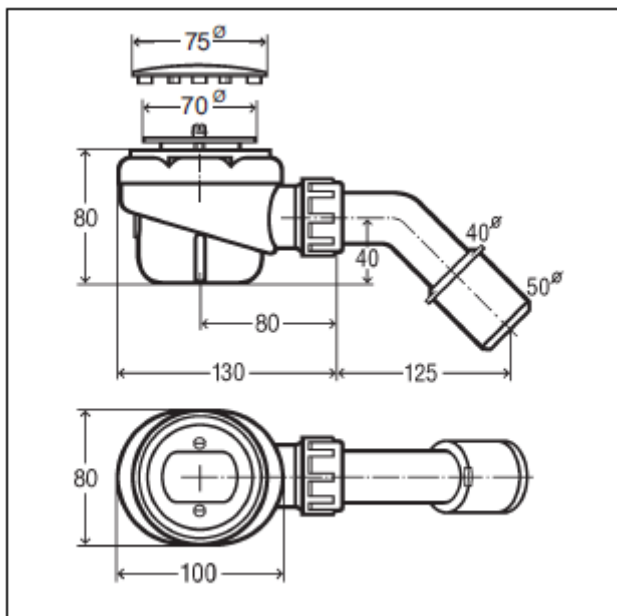

Assembly :

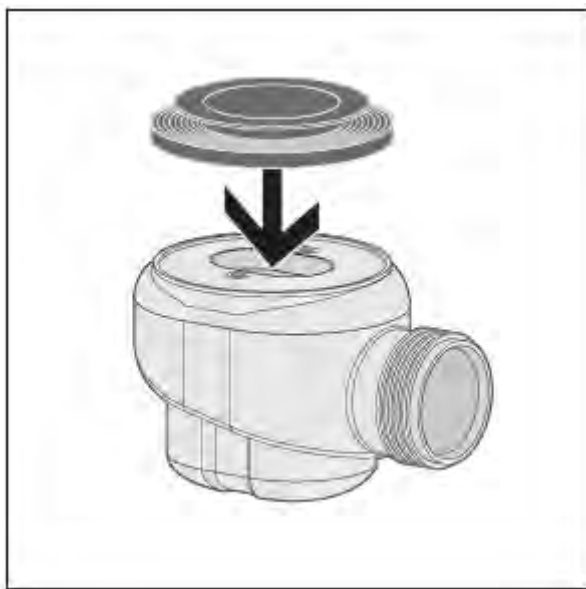

Proceed as follows to mount the drain:

Place the seal on the sealing surface of the drain and push into the holding groove.

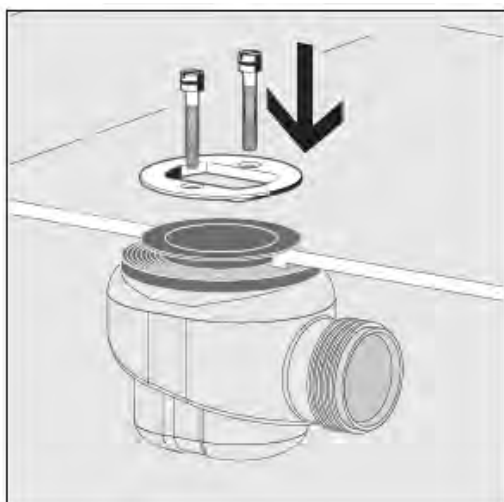

Position the drain unit with seal under the shower tray.

Push the upper part of the seal through the drain hole.

Secure drain



Place fixing flange and insert the screws by hand.

NOTICE! Only use a screwdriver, not a cordless screwdriver.

Tighten screws evenly.

Silicone Must Not Be Used

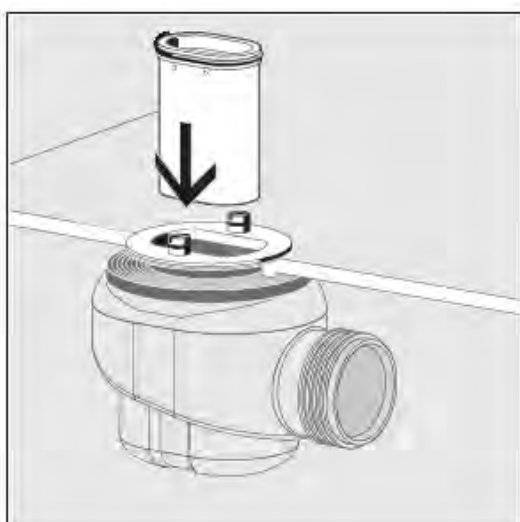

Insert immersion pipe into the odour trap.

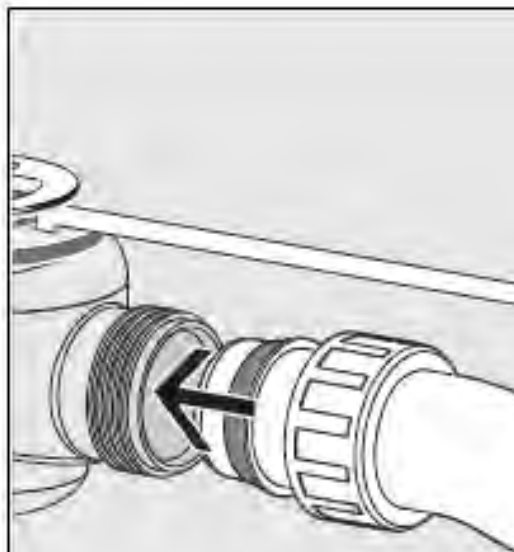

Push the union nut, sliding ring and seal onto the drain pipe.

Screw the union nut onto the drain unit.

Leakage test

The leakage test is only carried out as a visual inspection.

- Check drain fitting for visible leaks.

4. Maintenance/Cleaning

NOTICE!

Risk of damage due to unsuitable cleaning agent.

The following cleaning agents can damage chrome-plated surfaces and therefore may not be used:

- scouring agent
- abrasive sponges
- lime, plaster or cement dissolver
- solvents or other acidic cleaning agents

Normal soap or a mild cleaning agent can be used for regular care and prevention of lime scale on the rotatable rosette and valve cone. Under no circumstances should scouring agent or scratching objects be used.

Strong stains, even around the drain unit and the siphon, can be removed using typical household cleaner. It should be noted that the cleaning agent should be rinsed off after the prescribed soaking time.

There should be no residue on the components.

Cleaning the drain

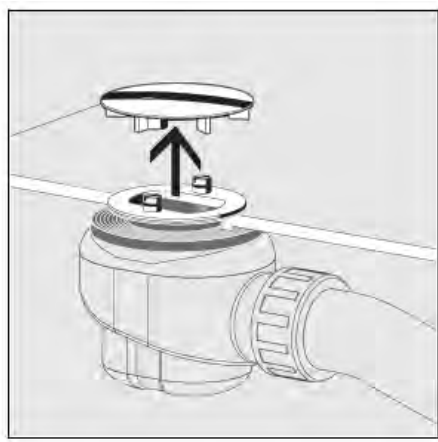

- Remove cover plate.

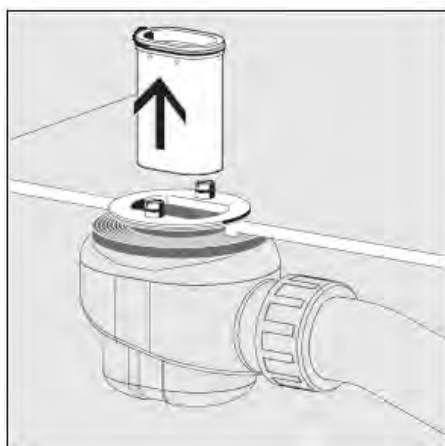

- Remove the immersion pipe upwards.

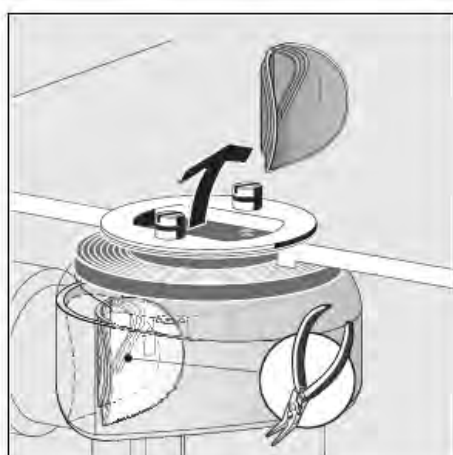

For free access to the drain pipe:

Grip the closing plug on the lug with pliers and pull off.

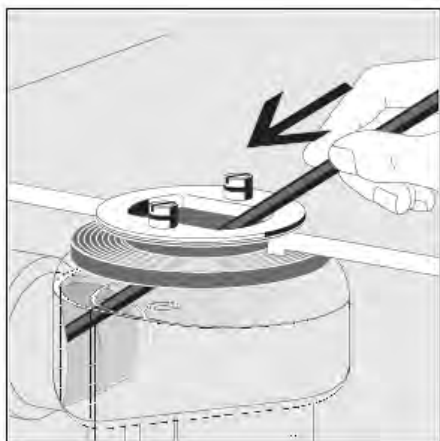

- Clean the drain carefully to avoid damaging the fitting.

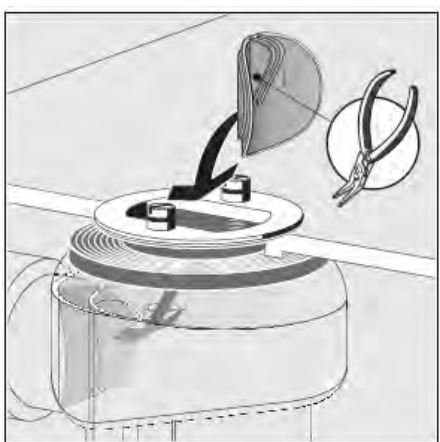

- Insert closing plug flush with the surface.

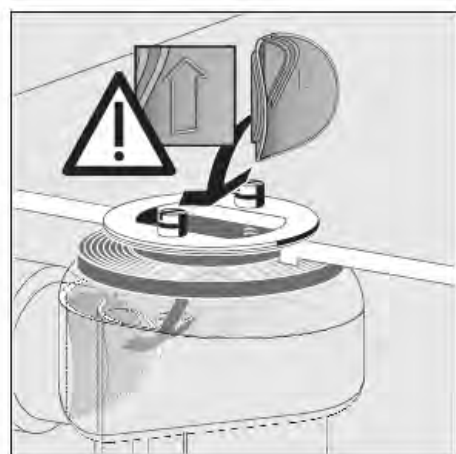

- Make sure to position the closing plug properly. The lug must be positioned vertically.

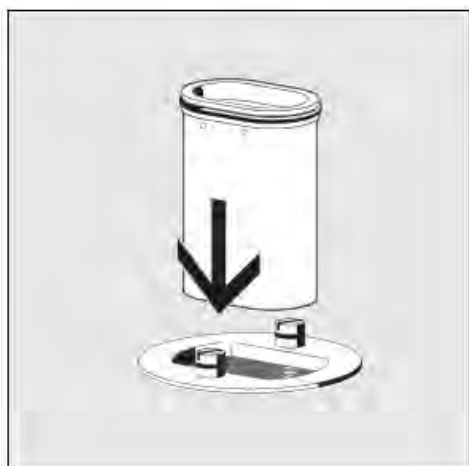

- Insert immersion pipe.



- Mount cover plate.